

az  
ha

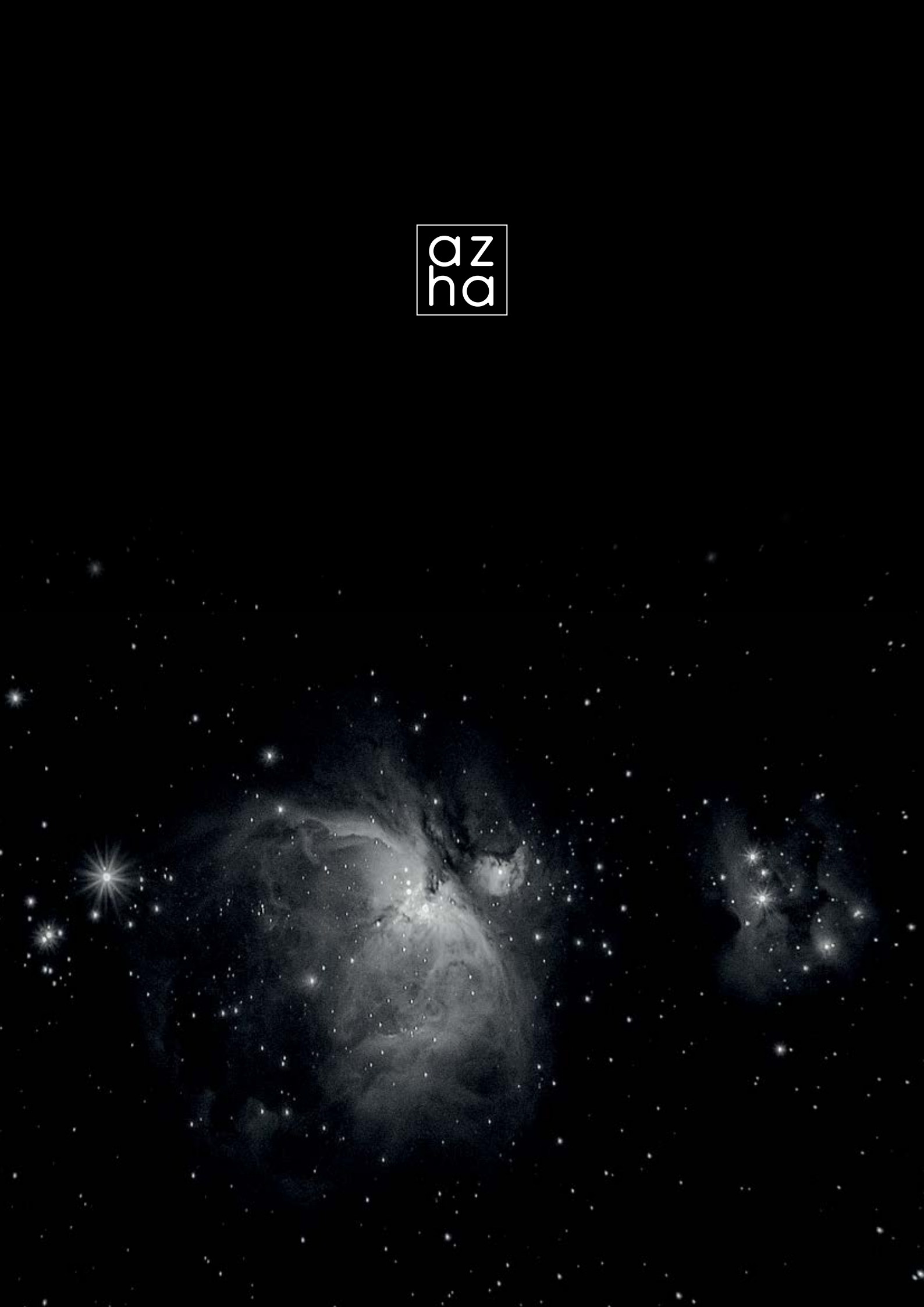

## CONTEXT

# STRONG & INCISIVE. IDENTITY & CHARACTER.

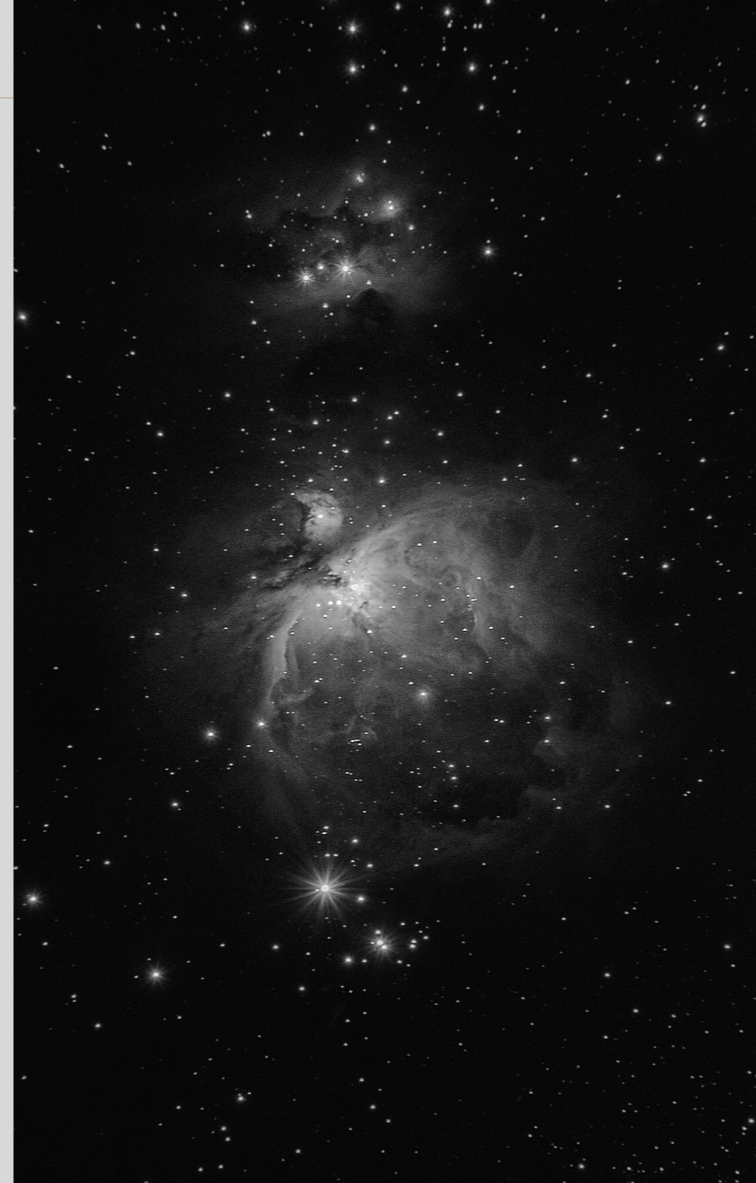

Azha, named after a giant star in the constellation of Eridanus, is a design brand of cosmetics for body & hair.



## COSMETIC OVERVIEW

Azha cosmetic collection is formulated with gentle ingredients and botanical extracts, such as Alfalfa and Mallow organic extract, Echinacea, Verbena and Watercress extracts. The body cream is enriched with Vitamin E and Shea butter, the conditioner is enriched with purified keratin and Chamomile extract. Discover the full body and bath collection made in Italy, clinically tested, without mineral oils or phenoxyethanol.



## AUTHENTIC DESIGN AND SMART ENGINEERING.

**Azha** cosmetic collection stands out due to its new dispenser solution which is the result of a fruitful design collaboration between Palomba Serafini studio and Gfl's design department. The creation is a perfect balance of elegant design and outstanding functionality. *The aim of the project is to offer an extremely aesthetic solution, flexible in its configurations and consistent with Gfl's philosophy that is increasingly attentive to the issues of environmental sustainability and the circular economy.*



EXCLUSIVELY  
DESIGNED FOR GFL BY

ps+a

ludovica + roberto palomba

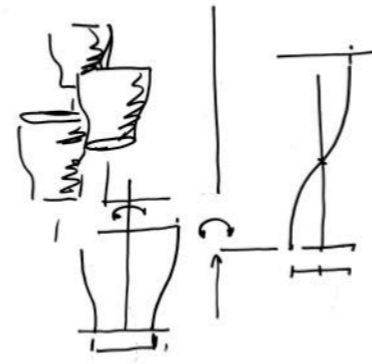

## ELEGANCE AND SUSTAINABILITY

Conceived to be an iconic piece of furniture, the Azha **"shelf system"** consists of two simple elements that hide the technical components of safety and functionality inside. The recycled ABS shelf is an interesting novelty both due to its functionality and the use of materials. The bottle, made of recycled plastic (92%) and 100% recyclable, is extremely ergonomic, safe and versatile.

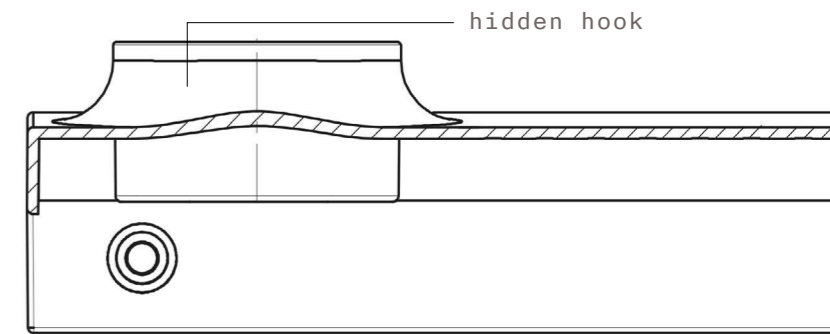

recycled ABS  
100% recyclable

## DESIGNED FOR USE

In addition to being an elegant dispenser, the shelf, in its long version, is designed to offer an additional support surface for personal objects.

Each creation is the result of coherent research, developing from an interaction of thoughts, inspirations and intuitions. Refusing any linear approach as well as all aesthetic and formal stylisms, Palomba and Serafini rediscover what being a designer means, thinking about the objects' function before designing their shape.



**FSS300SAZ**  
300 ml e 10,14 fl.oz  
**SHAMPOO**  
with Watercress extract

SHAMPOO  
con estratto di Crescione d'acqua  
SHAMPOOING  
aux extraits de Cresson d'Eau  
HAARSHAMPOO  
mit Brunnenkresse-Extrakten  
CHAMPÚ  
con extractos de Berro de Agua

**FSS300MAZ**  
300 ml e 10,14 fl.oz  
**HAIR & BODY WASH**  
with Echinacea and Verbena  
organic extracts

SHAMPOO DOCCIA  
con estratti biologici di Echinacea  
e Verbena  
GEL CORPS ET CHEVEUX.  
avec des extraits biologiques de  
fleurs Echinacée et de Verveine  
DUSCHGEL & SHAMPOO  
mit biologischen Extrakten des  
Sonnenhuts und Eisenkrauts  
GEL-CHAMPÚ  
con extractos biológicos de  
equinácea y Verbena

**FSS300BAZ**  
300 ml e 10,14 fl.oz  
**BODY WASH**  
with Alfalfa and Mallow  
organic extracts

GEL DOCCIA  
con estratti biologici di Erba  
Medica e Malva  
GEL DOUCHE  
aux extraits biologiques de  
Luzerne et de Mauve  
DUSCHGEL  
mit biologischen Extrakten  
der Luzerne und Malve  
GEL DE DUCHA  
con extractos biológicos de  
Alfalfa y Malva

**FSS300CAZ**  
300 ml e 10,14 fl.oz  
**CONDITIONER**  
with purified Keratin  
and Camomile extract

BALSAMO  
con cheratina purificata e  
estratto di Camomilla  
APRÈS-SHAMPOOING  
à la kératine purifiée et aux  
extraits de camomille  
HAARSPÜLUNG  
mit Keratin und Kamillenex-  
trakten  
ACONDICIONADOR  
con queratina purificada y  
extractos de manzanilla

**FSS300BLAZ**  
300 ml e 10,14 fl.oz  
**BODY LOTION**  
with Vitamin E and Shea Butter

CREMA CORPO  
Con vitamina E e burro di Karité  
CRÈME HYDRATANTE MAINS  
ET CORPS  
à la vitamine E et au beurre de karité  
KÖRPERCREME  
mit Vitamin E und Sheabutter  
LECHE CORPORAL  
con vitamina E y manteca de karité

**FSS300LMAZ**  
300 ml e 10,14 fl.oz  
**LIQUID HAND SOAP**  
with Guarana extract

SAPONE LIQUIDO  
con estratto di Guaraná  
SAVON LIQUIDE  
avec des extraits de Guarana  
FLÜSSIGE SEIFE  
mit Guarana-Extrakten  
JABÓN LÍQUIDO  
con extractos de Guaraná

**BACK**



**Cosmetic Specifications**

- 
- Ni
- V
- 
- 
- BHT
- 

- 
- 
- 
- 
- 
- 
- W/FI

- 
- 
- 
- 
- 
- 
- FI/C

- 
- 
- 
- 
- 
- 
- W/FI

- 
- 
- 
- 
- 
- 
- FI/C

- 
- 
- 
- 
- 
- 
- FI/C

- Dermatologically tested
- Nickel tested
- Vegan friendly
- No alcohol
- No petrolatum
- No BHT
- Fragrance

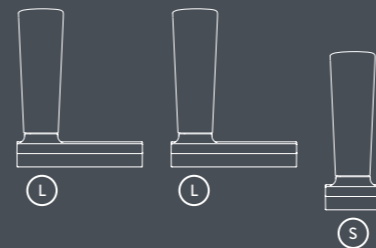
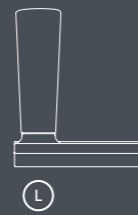
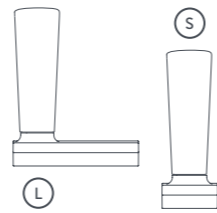
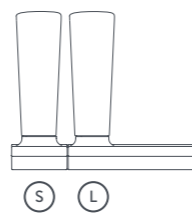
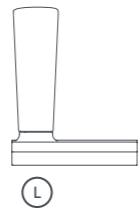
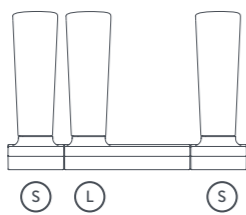
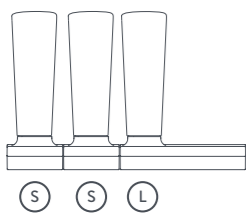
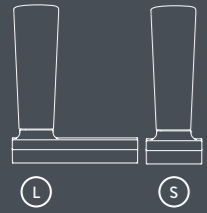

**PLAY AND MATCH**

Azha shelf system is extremely versatile and adaptable to many contexts and spaces. The shelf bases are available in two sizes: short and long. By combining the two formats, many combinations can be obtained.

Ⓢ Short Holder

Ⓛ Long Holder

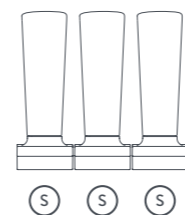
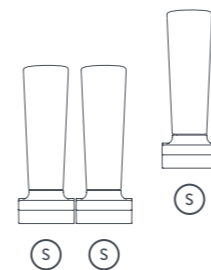





**SP092AZ**  
7x7x3 cm

**KONJAC SPONGE**  
with bamboo charcoal

**SPUGNA KONJAC**  
con carbone di bambù  
**EPONGE DE KONJAC**  
au charbon de bambou  
**KONJAC-SCHWAMM**  
mit Bambuskohle  
**ESPONJA KONJAC**  
con carbón de bambú



## Packaging Specifications



**Caps made of recycled PP**  
Tappi realizzati in PP riciclato  
Bouchons fabriqués en plastique PP recyclé  
Verschlüsse aus recyceltem PP  
Tapones realizados con PP reciclado



**100% recycled PET**  
PET 100% riciclato  
PET 100 % recyclé  
100% recycled PET  
PET 100% reciclado



**PE Label**  
Etichetta in PE  
Etiquette en PE  
PE Etikett  
Etiqueta de PE



**Caps made of recycled PP**  
Tappi realizzati in PP riciclato  
Bouchons fabriqués en plastique PP recyclé  
Verschlüsse aus recyceltem PP  
Tapones realizados con PP reciclado



**92% recycled PE**  
PE 92% riciclato  
PE 92% recyclé  
92% recycled PE  
PE 92% reciclado



**PE Label**  
Etichetta in PE  
Etiquette en PE  
PE Etikett  
Etiqueta de PE



**ABS Holder**  
Staffa di supporto in ABS  
ABS Support  
ABS Wandhalterung  
Soporte en ABS



**Soap wrapped in PP (20g - 40g)**  
Incarto saponi in PP  
Savon enveloppé en PP  
Seife eingewickelt in PP  
Jabón envuelto en PP



**All 100 % Recyclable**  
Tutto 100% Riciclabile  
Tout 100% recyclable  
Alles 100% recycelbar  
Todo 100% reciclable

## Shelf System

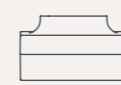

### SHORT HOLDER

Staffa di supporto corta  
Support court  
Kurze Wandhalterung zum Schrauben  
Soporte corto

White **SSC#BI**  
Gunmetal Gray **SSC#CF**  
Black **SSC#NE**

Recommended color: WHITE



### LONG HOLDER

Staffa di supporto lunga  
Support long  
Lange Wandhalterung zum Schrauben  
Soporte largo

White **SSL#BI**  
Gunmetal Gray **SSL#CF**  
Black **SSL#NE**

Recommended color: WHITE

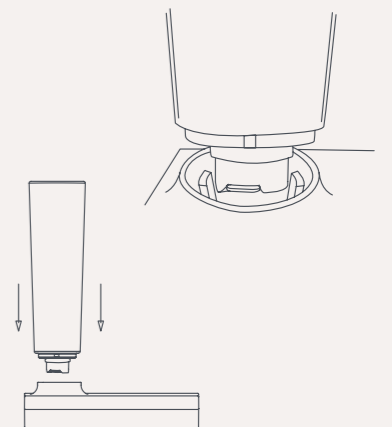

## Installation & Maintenance



**Install with screw**  
Installazione con viti  
Installation à vis  
Mit Schrauben installieren  
Instalación con tornillos



**Easy to combine in multiple arrangements. Download the instruction sheet here.**  
Facile da comporre in svariate combinazioni. Scarica le istruzioni di installazione qui.  
Facile à associer en différentes versions. Téléchargez la brochure d'instructions ici.  
Einfach zu kombinieren in verschiedenen Arrangements. Laden Sie hier die Bedienungsanleitung herunter.  
Fácil de combinar en diferentes soluciones. Descargar las instrucciones aquí.

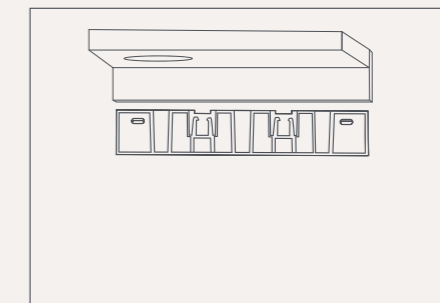
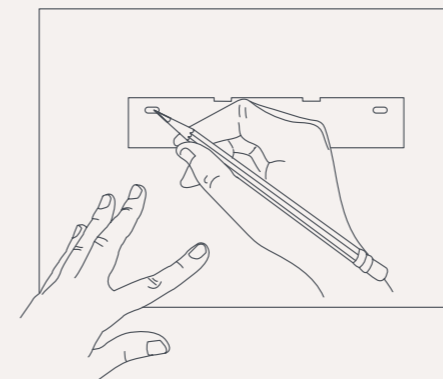

**Closure Anti-theft accessible with key**  
Chiusura antifurto apribile con chiave  
Fermeture antivol accessible avec une clé  
Diebstahlsicherung mit Schlüssel zu öffnen  
Cierre antirrobo accesible con llave



**GFL SA**

Via Sorengo 1, (CH) 6900 Lugano  
T +41(0)91 9607500  
F +41(0)91 9607599  
info@gflamenities.com  
www.gflamenities.com

**GFL USA Inc.**

205 Hudson St, New York, NY  
10013, USA  
T +1 (718) 414-2554  
info@gflamenities.com  
www.gflamenities.com

**GFL Middle East Cosmetics  
Trading LLC**

ESPADA business center  
Office #17, PO BOX 282556,  
502, 5th Floor, Rasis building  
Al Barsha 1, Dubai - UAE  
T +971 4 315 98 14  
info@gflamenities.com  
www.gflamenities.com